

**ANDREW YULE & CO. LTD.
CHOONABHUTTI TEA ESTATE
(A Government of India Enterprise)
BANARHAT, JALPAIGURI, WEST BENGAL, 735202.**

NOTICE INVITING TENDERS

Choonabhutti Tea Estate on behalf of ANDREW YULE & CO. LTD invites e-Tender under two part system (**Part I: Techno-Commercial Bid and Part II: Price Bid**) from bona fide and reputed **Company/Firm** for **construction of CTC Cooling chamber with Electrical arrangements at Choonabhutti Tea Estate**, the details of which are available in Annexure-IV "**Scope of Work / Technical Specification**" as specified in this tender document.

Tender document may be downloaded from MSTC website www.mstcecommerce.com/eprochome/aycl or www.andrewyule.com. Corrigenda or clarifications, if any, shall be hosted on the above mentioned websites only. AYCL reserves the right to accept or reject any tender.

Schedule of Tender

1.	TENDER NO.	CH/CAPEX/18-19/01 Dated. : 15.10.2018
2.	MODE OF TENDER	e-Procurement System Online submission of Part I - Techno-Commercial Bid and Part II - Price Bid through www.mstcecommerce.com/eprochome/aycl The intending bidders are required to submit their offer electronically through this e-tendering portal. No physical tender is acceptable by AYCL/MSTC
3.	E-Tender No. / Event No.	AYCL/TEA DIVISION/47/18-19/ET/208
4.	Date of publication of e-Tender through publication MSTC/AYCL websites and Central Public Procurement Portal	15/10/2018
5.	Date of availability of NIT to the Vendors for downloading	15/10/2018
6.	Earnest Money and other document	<input type="checkbox"/> "Earnest Money Deposit" of Rs.3000.00 (Rupees three thousand only) may be paid by D.D. favouring Andrew Yule &Co Ltd. A/c Choonabhutti Tea Estate payable at banarhat/Siliguri. <input type="checkbox"/> Other document as described in Annexure – I, Sl. No. 2

7.	Last date of submission of EMD & other documents to the Manager, Choonabhutti Tea Estate with an email confirmation to Chief General Manager, Tea Division at kaustuv.roy@andrewyule.com	31/10/2018
8.	Date of Starting of e-Tender for submission of Online Techno-Commercial Bid and Price Bid at www.mstcecommerce.com/eprochome/aycl	To be intimated to the eligible vendor separately by email as well as through Corrigendum in the website.
9.	Date of closing of Online e-tender for submission of Techno-Commercial Bid & Price Bid at www.mstcecommerce.com/eprochome/aycl	To be intimated to the eligible vendor separately by email as well as through Corrigendum in the website.
10.	Date & time of opening of Part-I (Techno-Commercial Bid)	To be intimated to the eligible vendor separately by email as well as through Corrigendum in the website.
11.	Date & time of opening of Part-II (Price Bid)	To be intimated to the eligible vendor separately by email as well as through Corrigendum in the website.

List of Annexure

Important Instructions for E-procurement -	Annexure-I
Notice Inviting Tender	Annexure-II
General Information-	Annexure-III
Scope of Work / Technical Specification/ General Terms& Conditions	Annexure-IV

**ANDREW YULE & CO. LTD.
CHOONABHUTTI TEA ESTATE**

Important Instructions for E-procurement

Ref. E-Tender No.: AYCL/TEA DIVISION/47/18-19/ET/208

Ref. Tender No.: CH/CAPEX/18-19/01

This is an e-procurement event of Choonabhutti Tea Estate, located at Banarhat, Jalpaiguri, of ANDREW YULE & COMPANY LTD Ltd.

You are requested to read the Terms & Conditions (Annexure- III, IV) of this tender before submitting your online tender. Tenderers who do not comply with the Conditions with documentary proof (wherever required) will not qualify in the Tender for opening of Price Bid.

1. Process of E-tender:

A) **Registration:** The process involves vendor's registration with MSTC e-procurement portal which is free of cost. Only after registration, the vendor(s) can submit his/their bids electronically. Electronic Bidding for submission of Techno-Commercial Bid as well as Price Bid over the internet will be done. The Vendor should possess Class III signing type Digital Signature Certificate. Vendors are to make their own arrangement for bidding from a PC connected with Internet. MSTC is not responsible for making such arrangement. (Bids will not be recorded without Digital Signature).

SPECIAL NOTE: THE PRICE BID AND THE COMMERCIAL BID HAS TO BE SUBMITTED ON-LINE AT www.mstcecommerce.com/eprochome/aycl

- 1) Vendors are required to register themselves online with www.mstcecommerce.com → e-Procurement → PSU / Govt. depts. → Register as Vendor under AYCL- Filling up details and creating own user id and password → Submit.
- 2) Vendors will receive a system generated mail confirming their registration in their email which has been provided during filling the registration form.

In case of any clarification, please contact MSTC/AYCL (before the scheduled time of the e-Tender).

Contact person for Techno Commercial clarification (ANDREW YULE & COMPANY LTD):

1. S. Sinhababu
Sr. Manager,
Choonabhutti Tea Estate, Banarhat, Jalpaiguri.
Contact No: 03563-258384
Email: yule.choonahutti@gmail.com

Contact person for Techno Commercial clarification (E-Commerce, MSTC Ltd):

- | | |
|--|---|
| <p>1. Mr. Pritam Biswas
Assistant Manager (ERO),
MobileNo: 9903248755,
Email: pbiswas@mstcindia.co.in</p> | <p>2) Mr. Mayank Jain,
Assistant Manager (ERO),
Mobile- 9721277969,
Email: mhjain@mstcindia.co.in</p> |
| <p>2. Mr. Vikash Kumar Jaiswal
Regional Manager (ERO),
Mobile- 9903042449,
Email: vikash@mstcindia.co.in</p> | |
| <p>3. Landline: (033) 22901004</p> | |

System Requirement:

- i) Windows XP-SP3 or above / Windows 7 Operating System
- ii) IE-7 or above Internet browser.
- iii) Signing & Encryption type digital signature
- iv) JRE 7 update 79 software to be downloaded and installed in the system. Security level should be medium
- v) To enable ALL active X controls and disable 'use pop up blocker' under Tools → Internet OpJons → custom level (Please run IE settings from the page www.mstcecommerce.com once)

2. Part-I: Submission of EMD & other Documents:

Within specified Date & time the vendor must submit the following documents to Manager , Choonabhutti Tea Estate, P.O. : Banarhat, Dist : Jalpaiguri, West Bengal, 735202, Off-line.

- Earnest Money of Rs.3000.00 (Rupees three thousand only) by Demand Draft favouring Andrew Yule & Co. Ltd. A/C Choonabhutti Tea Estate, Payable at Banarhat/Siliguri.
- General information, under Annexure-III complete in all respect along with desired information and document.
- Acceptance of Scope of Work/Technical Specification/Drawing, under Annexure-IV along with relevant information and documents without Price Sheet.
- Technical specification sheet & Drawing, with all desired details, duly signed and stamped as token of acceptance.

In case of failure to submit the EMD and other document within the stipulated time, the Tender may be rejected.

Part-II: Online Bid submission: On the basis of submission of EMD and other Documents at Choonabhutti Tea Estate, P.O.: Banarhat, Dist: Jalpaiguri, West Bengal, 735202, the list of vendors who will participate in online Techno commercial and price bid submission will be finalized. Only those qualified bidders will be eligible to submit Online Techno-commercial and price bid.

Bidding in e-Tender:

- a. No interest will be paid on EMD. EMD of the unsuccessful bidder(s) will be refunded by Choonabhutti Tea Estate. EMD to be paid along with the Document with in the last date as mentioned in SOT.
- b. The process involves Electronic Bidding for submission of Techno Commercial Bid as well as Price Bid.
- c. The bidder(s) who have submitted the EMD and documents to Choonabhutti Tea Estate will be short listed by Manager, Choonabhutti Tea Estate and those qualified bidders can only submit their Techno Commercial Bids and Price Bid through internet in MSTC website www.mstcecommerce.com → e-procurement → Psu / Govt depts. → Login under AYCL → My Menu → Auction Floor Manager → live event → Selection of the live event.
- d. The bidder should allow to run an application namely enApple by accepting the risk and clicking on run. This exercise has to be done twice immediately after opening of Bid floor. Then they have to fill up Common terms /Commercial specification and save the same. After that clicking on the Techno-Commercial bid, if this application is not run then the bidder will not be able to save / submit his Techno-Commercial bid.
- e. After filling the Techno-Commercial Bid, bidder should click 'save' for recording their Techno-Commercial bid. Once the same is done, the Price Bid link becomes active and the same has to filled up and then bidder should click on "**Save**" to record their Price Bid. Then once both the Techno-Commercial bid & Price Bid has been saved, the bidder can click on the "**Submit**" button to register their bid.
- f. Vendors are instructed to use link in **My Menu** to **Upload Documents** in document library. Multiple documents can be uploaded. Maximum size of single document for upload is 5 MB.
- g. Once documents are uploaded in the library, vendors can attach documents through *Attach Document* link against the particular tender. For further assistance please follow instructions of vendor guide.
- h. In all cases, bidder should use their own ID and Password along with Digital Signature at the time of submission of their bid.
- g. During the entire e-tender process, the bidders will remain completely anonymous to one another and also to everybody else.

- h. The e-tender floor shall remain open from the pre-announced date & time and for as much duration as mentioned above.
- i. Techno-Commercial bid will be opened electronically on specified date and time as given in the NIT. Bidder(s) can download Technical Comparative statement.
- j. Price bid will be opened electronically on specified date and time given in the NIT. Bidder(s) can download Price Comparative statement.
- k. All entries in the tender should be entered in online Technical & Commercial Formats without any ambiguity.
- l. All electronic bids submitted during the e-tender process shall be legally binding on the bidder. Any bid will be considered as the valid bid offered by that bidder and acceptance of the same by the Buyer will form a binding contract between Buyer and the Bidder for execution of supply. Such successful tenderer shall be called hereafter **SUPPLIER**.
- m. It is mandatory that all the bids are submitted with Digital Signature Certificate otherwise the same will not be accepted by the system.
- n. Buyer reserves the right to cancel or reject or accept or withdraw or extend the tender in full or part as the case may be without assigning any reason thereof.
- o. No deviation of the terms and conditions of the tender document is acceptable. Submission of bid in the e-tender floor by any bidder confirms his acceptance of terms & conditions for the tender.
- p. Unit of Measure (UOM) is indicated in the e-tender Floor. Rate to be quoted should be in Indian Rupee as per UOM indicated in the e-tender floor/tender document.

E-tender cannot be accessed after the due date and time mentioned in NIT.

All notices / corrigendum and correspondence to the bidder(s) shall be sent by email only during the process till finalization of tender by Choonabhutti TEA ESTATE/ANDREW YULE & COMPANY LTD/MSTC LTD. Hence the bidders are required to ensure that their corporate email I.D. provided is valid and updated at the stage of registration of vendor with MSTC. Bidders are also requested to ensure validity of their DSC (Digital Signature Certificate).

Any order resulting from this open e-tender shall be governed by the terms and conditions mentioned therein.

No deviation to the technical and commercial terms & conditions are allowed.

ANDREW YULE & COMPANY LTD / Choonabhutti Tea Estate has the right to cancel this e-Tender without assigning any reason thereof.

The online tender should be submitted strictly as per the terms and conditions and procedures laid down in the website www.mstcecommerce.com/eprochome/aycl of MSTC Ltd.

The bidders must upload all the documents required as per terms of NIT. Any other document uploaded which is not required as per the terms of the NIT shall not be considered.

The bid will be evaluated based on the filled-in technical & commercial formats.

Bidders are requested to read the vendor guide and see the video in the page www.mstcecommerce.com/eprochome/mstc of MSTC Ltd. to familiarize them with the system before bidding.

Notice Inviting Tender:
Ref. E-Tender No.: AYCL/TEA DIVISION/47/18-19/ET/208
Ref. Tender No.: CH/CAPEX/18-19/01

Choonabhutti Tea Estate on behalf of Andrew Yule & Co. Ltd., Tea Division, wants to construct CTC Cooling chamber with Electrical arrangements at Choonabhutti Tea Estate located at the factory.

Offers are invited from reputed and competent vendors for such job at specified locations.

Vendors/Suppliers interested to participate in the above Tender will have to :

- b) Get themselves registered (free of cost) as supplier with www.mstcecommerce.com/eprochome/aycl, our service provider.
- c) Submit the following document to Choonabhutti Tea Estate, Banarhat, Jalpaiguri, West Bengal within 15 days from the date of publication of advertisement, off line -
 - General Information Sheet complete in all respect duly signed and stamped.
 - Earnest money of Rs.3000/- by Draft favouring Andrew Yule & Co. Ltd. A/C Choonabhutti Tea Estate payable at Banarhat/Siliguri.
 - Commercial Terms & Conditions Sheet, duly signed and stamped as token of acceptance.
 - Technical specification sheet with Drawing, with all desired details, duly signed and stamped as token of acceptance.

The following pre-qualification criteria would apply, which may be relaxed at the sole discretion of Andrew Yule & Co. Ltd. / Choonabhutti Tea Estate.

- The Bidder should be having minimum 3 years of Construction experience and holding authority to deal with Andrew Yule & Co. Ltd. / Choonabhutti Tea Estate, for the job quoted for. This should be supported by appropriate documentary evidence.
- The Bidder shall be a registered Company/Firm and posses valid PAN / GST registration certificates.
- The Bidder should have own local support office / franchisee presence for the locations namely Banarhat / Siliguri and should be able to provide a Service Engineer as and when required.

General Information**Ref. E-Tender No.: AYCL/TEA DIVISION/47/18-19/ET/208****Ref. Tender No.: CH/CAPEX/18-19/01**

The applicants are required to furnish full information to the queries included in this form. In giving the particulars, the supporting documents/certificates as called for per queries at places, must be tagged with the application for evidencing the information furnished in the application.

1. Particulars of Company

- 1.1 Name of the Company :
- 1.2 Nature of business :
- 1.3 Full address :
- 1.4 Phone No. :
- 1.5 Fax No. :
- 1.6 E-mail ID :

2. Details of Certificate

SI No.	Particulars	Registration No.	Remarks
1.	Income Tax		Copy of Registration Certificate / PAN Card to be attached
2.	GST		Copy of Registration Certificate to be attached
5.	Trade Licence		Copy to be attached

3. List of Service Centers

Sl. No	Location	Type of Centre		Bidders to Provide full address & Telephone No
		Company Operated	Franchised	
1	Banarhat/Dhupguri/Malbazar			
2	Siliguri			

4. Details of Banker

1	Name of the Bank	
2	Name of the Branch	
3	Branch Code	
4	Address	
5	IFSC Code No.	
6	Account No.	

5. List of jobs of identical nature made in last 3 years with customer reference

6. Copies of Purchase Orders : received from major Customer for identical type of items (minimum 3 order copies)

I/we hereby certify that the particulars furnished by me/us above are true to the best of my / our knowledge and belief and mis-representations of facts will render me/us liable to my/our action as may be deemed fit by Andrew Yule & Co. Ltd. (Tea Division) / Choonabhutti Tea Estate & have the sole discretion to reject or accept my/our candidature.

Signature of the Applicant)
Office Stamp/Seal.

Place :

Date ;

List of Enclosures :

General Terms & Conditions**Ref. E-Tender No.: AYCL/TEA DIVISION/47/18-19/ET/208****Ref. Tender No.: CH/CAPEX/18-19/01****1. Scope of Work**

(A) 10" th. Brick wall upto 3' ht. & 5" th. Brick Masonary wall upto 7' ht. With bothsides Plastering (B) RCC column, GL Beam, RCC lintel, T-beam, Roof (C) M.S. Gate 1 no. x 4' x 7' ht. (D) Fixing M.S. welded mesh over M.S. Angle frame work upto 5' ht. (E) White washing, Primming, Painting (F) Electrical arrangements with Labour charges .

- Commissioning at site.

2. Location of Site

- Factory of Choonabhutti Tea Estate, P.O. Banarhat, Dist. Jalpaiguri, West Bengal.

3. Liquidated Damage

In the event of failure on the part of the contractor to complete entire work against the order to our full satisfaction within the specified period of completion, we may recover from the contractor as liquidated damages, a sum equivalent to ½% of contract value for each week or any part thereof default, where the delivery thereof will be accepted after expiry of the date stipulated for this purpose, but limited to a maximum of 10% of contract value

4. Force Majeure

Any delay or failure in the performance of either party hereto will not constitute default thereunder or give rise to any claim for damages, if any, to the extent such delays or failure of performance is caused by the occurrence such as acts of god or the public enemy, appropriation or confiscation of facilities by Govt. Authorities, acts of war, rebellion or sabotage, fires, explosions, riots and illegal strike.

5. Risk Purchase

In case the contractor fails to execute the contract fully or partly, the purchaser shall have the right to execute the work through other agencies, as decided by the purchaser at the contractor's cost and risk after giving two weeks notice in writing.

6. Terms of payment

- Part payment will be released according to the progress of work with 10% retention at each stage described in the scope of work which will be returned after 1 year of completion of the project if no dispute arises regarding quality of the project.
- Statutory deductions will be made as per rules.

7. Price Variation

The quoted price should remain firm during pendency of the contract.

8. The tenderers are requested to ensure Earnest Money Deposit along with the Tender in the following manner, which will be converted into Security Deposit for the successful bidder/s and will be released on completion of job.

EMD Amount ---- Rs.3000/-

EMD to be submitted by D.D.favouring Andrew Yule & Co. Ltd. A/C Choonabhutti Tea Estate payable at Banarhat/Siliguri.

9. Decision for awarding contract/job is vested with the Management so as to reject.
10. Incomplete "Quotation/Offer" is liable to be rejected.
11. The offer must be valid for a minimum of 90 days from the date of E-Bidding.
12. Replacement of the defective/substandard material/job has to be made good within 15 days.
13. Management reserves the right of pre-delivery inspection.
14. Management reserves the right to split the order wherever found necessary with majority job to be reserved for L1.
15. Job to be completed within 60 days from the date of Order.
16. All the applicable labour laws relating to deployment of labourers/employees will be strictly followed in executing the contract.
17. All disputes are subject to Jalpaiguri Jurisdiction only.

Signature of the Applicant)
Office Stamp/Seal.

Place :

Date ;

Technical specification and requirement

Ref. E-Tender No.: AYCL/TEA DIVISION/47/18-19/ET/208

Ref. Tender No.: CH/CAPEX/18-19/01

Scope of Work :

(A) 10" th. Brick wall upto 3' ht. & 5" th. Brick Masonary wall upto 7' ht. With bothsides Plastering (B) RCC column, GL Beam, RCC lintel, T-beam, Roof (C) M.S. Gate 1 no. x 4' x 7' ht. (D) Fixing M.S. welded mesh over M.S. Angle frame work upto 5' ht. (E) White washing, Primming, Painting (F) Electrical arrangements with Labour charges .

Sl. No.	PARTICULARS OF WORK	QTY .	UNIT
1)	Earth Work in excavation of foundation trenches or drains in all sorts of soil (including mixed soil but excluding latrite soil or sandstone) including removing, spreading or stacking the spoils with in a lead of 75 m as directed. The item includes necessary trimming the sides of trenches, levelling, dressing, and ramming the bottom, bailing out water as required complete . (a) Depth of excavation not exceeding 1.50 M	9.50	Cu.M.
2)	Earth work in filling in foundation and trenches or plinth etc. in layers not exceeding 150 mm includinng watering and ramming etc. complete . (a) With earth obtained from excavation of foundation .	1.90	Cu.M.
	(b) with earth obtained by fresh excavation (including cost of excavation upto 1.80 m depth from land arranged by Deptt.) Within a lead of 100 m.	7.60	Cu.M.
3)	Single B.F.S. of picked jhamma bricks including ramming and dressing bed to proper level and filling joints with powdered earth or local sand .	18.13	Sq.M.
4)	Cement Concrete (1: 3: 6) with 40 mm down graded shingles excluding shuttering.	1.360	Cu. M.

5)	Ordinary Cement Concrete M 15 (mix 4: 2: 1) with 20 mm down graded stone chips / shingles excluding shuttering and reinforcement if any, in ground floor . (a) River Bazree -	7.057	Cu. M.
6)	Hire and labour charges for shuttering with centering and necessary centering and necessary staging upto 4.0 m staging upto 4.0 m using approved stout props & thick hard wood planks of approved thickness with required bracing for concrete slabs, beams, columns, lintels, curved or straight including fitting fixing and striking out after completion of works (upto roof of Ground floor) . (f) 25 to 30 mm thick wooden shuttering as per direction of Eng-In-Charge .	72.00	Sq.M.
7)	Reinforcement for reinforced concrete work in the all sorts of structures including distribution bars, stirrups, binders etc. including supply of rods, initial streaghtening and removal of loose rust (if necessary), cutting to requisite length, hooking and bending to correct shape, placing in proper position and binding with 16 gauge black annealed wire at every intersection, complete as per drawing and direction . (a) For works in foundation, basement and upto roof of ground floor / upto 4.0 m . (i) Tor Steel / Mild steel . @ 1.20 % of (C.C. work for M15) 7.057 Cu.M =	6.65	Quintel
8)	Brick work with 1 st class bricks in cement mortar (6 : 1) . (a) In foundation & plinth	3.440	Cu. M.
9)	125 mm thick brick work with 1st class bricks in cement mortar (4 : 1) in ground floor . Cable line trench -	14.880	Sq.M.
10)	Artificial stone in floor, dado, staircase etc. with cement concrete (4:2:1) with stone chips laid in panel as directed with topping made with ordinary or white cement (if necessary) and marble dust in propertion (2:1) including smooth finishingand rounding off corners and including application of cement slurry before flooring works using cement @ 1.75 Kg /		

	<p>Sq.M all complete including all materials and labour .</p> <p>3 mm thick topping with ordinary cement (High polishing grinding on this item is not permitted) .</p> <p>(a) 20 mm thick -</p>	5.76	Sq.M.
11)	<p>Supplying, fitting and fixing steel doors with or without integrated grills conforming to I.S. 7452 - 1973 with non friction projecting type hinges, glazing chips, lugs, locking plate, peg stays, 1.25 mm thick M.S. sheet welded kicking plates in double tray construction brass door handle with minimum 4 lever mortice lock openable with key both from inside and outside together with a locking bolt on the inside face including hoisting in position, straightening, if required fixing lugs in cement concrete (1:2:4) with stone chips 20 mm size cutting holes and mending good damages to match with existing surface complete in all respect including glazing .</p> <p>(b) Openable steel Door / windows -</p>	2.520	Sq.M.
12)	<p>Supplying fitting and fixing I.R.C. fabric mesh with covering battens including cost of screws etc complete (excluding the cost of battens</p> <p>(b) 75mm x 25mm x 2.7mm x 2.7mm.</p>	10.800	Sq.M.
13)	<p>M.S. works in framed gratings of window etc.made of round or square bars and frame work or M.S. flats (with the bars securely fixed to the flat bar frame) with or without intermediate flat bar stiffener and fixed with necessary screws etc. complete , as directed</p> <p>(a) In Ground Floor -</p>	1.500	Quintel
14)	<p>Plaster (to wall, floor, ceiling etc.) with sand and cement mortar including rounding off or chamfering corners as directed and racking out joints or roughening of concrete surface including throadting, nosing and drip course where necessary in G. floor .</p> <p>(i) With (6 : 1) cement mortar (b) 20 mm thick plaster</p> <p>(c) 15 mm thick plaster</p>	96.00 30.00	Sq. M Sq. M

15)	Neat cement punning about 1.50 mm thick in wall, Dado, window sills, floor, drain etc. Cement to be used 0.152 Cu.M per 100 Sq.M	15.00	Sq. M
16)	Red oxide wash of approved shade including cleaning and smoothening surface thoroughly (without specific permission from the Engineer in charge this item of work must not be done on an old painted surface which has not received such red oxide wash before). (b) One coat -	10.00	Sq.M.
17)	Painting with best quality synthetic enamel paint of approved make and brand including smoothening surface by sand papering etc. including using of approved putty etc. on the surface if necessary (b) On steel or metal surface (iv) Two coats (with any shade except white)	10.00	Sq.M.
18)	White washing including cleaning and smoothening surface thoroughly (5 parts of stone lime and 1 part of shell lime should be used in the finishing coat). (b) Two coats -	100.00	Sq.M.
19)	Making, Fitting & Fixing GI Sheet strip partition wall in between two chambers complete	145.00	Kg
20)	<u>Electrical Arrangements with Labour Cost :-</u> (a) Motor for Blower (2 HP, 2850 RPH) - (b) L & T Main Switch FN (63A , TPN) with Box - (c) L & T FASD Starter MK1 9-14 A - (d) L & T DOL Starter MK1 4-6.5A - (e) L & T MCB 32A T/P 10 KA - (f) L & T MCB 20 A T/P - (g) L & T MCB DB 6 Way SPN S/D - (h) Cable 35 Sq.MM Armond Cable - (I) Cable 4 Sq.MM -	2.00 1.00 1.00 1.00 1.00 1.00 1.00 50.00 15.00	Nos . No . No . No . No . No . No . Mtr. Mtr.

	(j) Electrical Assesories -	L. S.	L. S.
	(k) V Pully 6" -	2.00	Nos .
	(l) V Pully 12"	1.00	No .
-	(m) Bearing (1310 k with Slevs) -	2.00	Nos .
	(n) L & T HRC Fuse 63 A HF Type	3.00	Nos .
-			

Place :
Date :

Signature of the Applicant)
Office Stamp/Seal.

Drawing for Fabrication of Cooling & Ducting arrangement

Ref. E-Tender No.: AYCL/TEA DIVISION/47/18-19/ET/208

Ref. Tender No.: CH/CAPEX/18-19/01

Cooling & Ducting/1

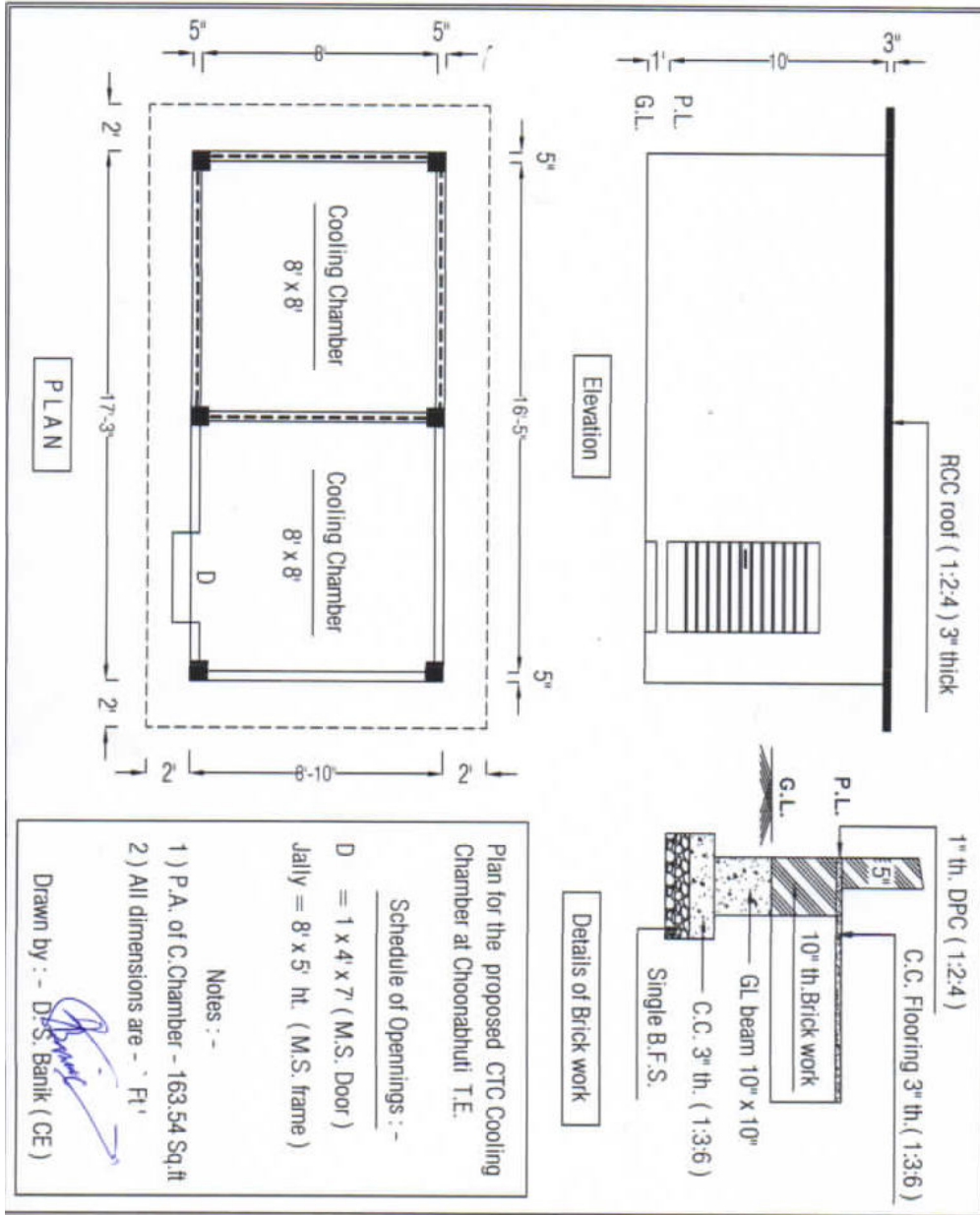

Place :
 Date :

Signature of the Applicant)
 Office Stamp/Seal.

For Online submission

ANNEXURE - V

Price Sheet for Construction of CTC Cooling chamber with Electrical arrangements

Ref. E-Tender No.: AYCL/TEA DIVISION/47/18-19/ET/208

Ref. Tender No.: CH/CAPEX/18-19/01

Garden : Choonabhutti Tea Estate, West Bengal

Item : Construction of CTC Cooling chamber with Electrical arrangements

Sl. No.	Name of Items	VALUE (in Rs.)	GST	TOTAL VALUE (in Rs.)
01.	Construction of CTC Cooling chamber with Electrical arrangements (as detailed in Annexure – IV under Technical Specification of Work & as per Drawing “Cooling & Ducting/1”)			